

Installation instruction

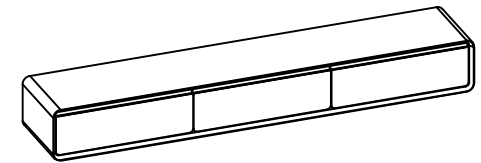

TS2001B/BWD/WWD/WD Installation

The number of people needed for installation: 2

- ① Please read the manual carefully before installing this product. And strictly follow the installation process
- ② Please take good care of this manual for your next installation
- ③ Note: Before installation, screw all the screws to 1/2 of the length of the installation. After all screws are half screwed in, tighten them all together.

Parts list

On a red ribbon are furniture installation accessories

Serial number	Shape	Name	Quantity required for installation	Spare quantity
A		Self-tapping screw (M4*50mm)	8	2
B		Expansion screw plug for wall installation	8	2
C		Self-tapping screw (M4*30mm)	4	2
D				
E				
F				
G				

1. Place the wall-mounted backboard at a suitable position on the wall, mark the holes to be installed on the wall and the backboard with a marker, and then drill holes on the wall with an electric drill.

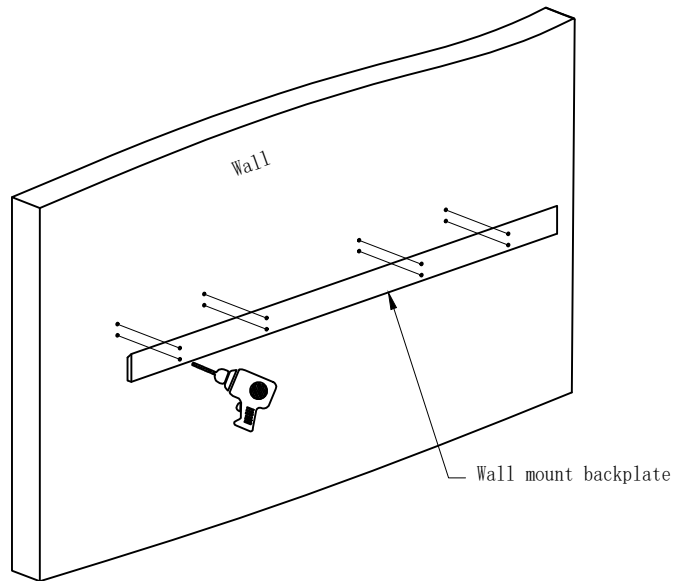

2. After the drilling is completed, insert the expansion plug into the wall hole, place the wall-mounted backboard, and insert the self-tapping screw into the position where the wall hole connects to the backboard hole. Tighten the screws with a screwdriver.

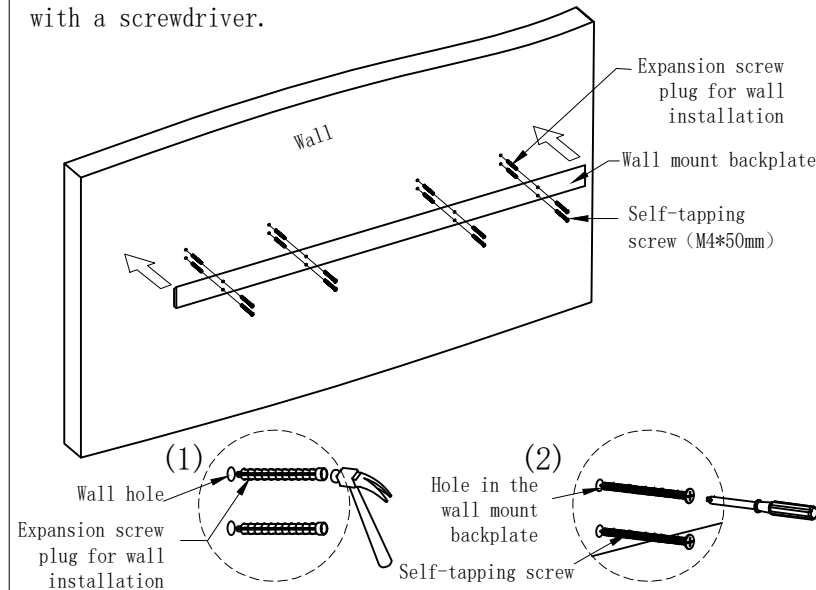

3. Put the TV cabinet on the wall-mounted backboard, open the downward door, insert the self-tapping screws into the holes of the cabinet body, and tighten them with a screwdriver or electric drill.

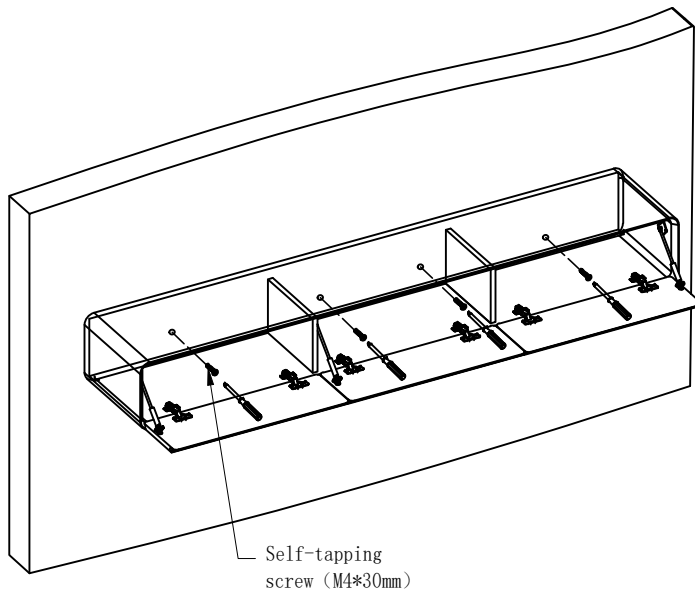

4. Installation complete

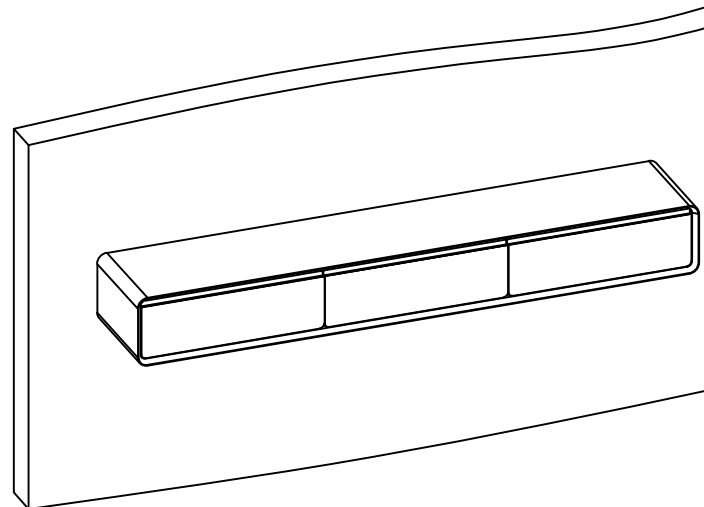

Installation instruction

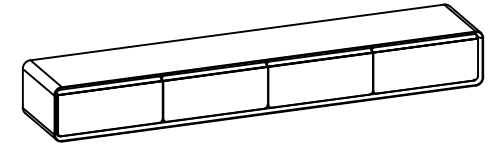

TS2001B24/BWD24/WWD24/WD24 Installation

The number of people needed for installation: 2

- ① Please read the manual carefully before installing this product. And strictly follow the installation process
- ② Please take good care of this manual for your next installation
- ③ Note: Before installation, screw all the screws to 1/2 of the length of the installation. After all screws are half screwed in, tighten them all together.

Parts list

On a red ribbon are furniture installation accessories

Serial number	Shape	Name	Quantity required for installation	Spare quantity
A		Self-tapping screw (M4*50mm)	8	2
B		Expansion screw plug for wall installation	8	2
C		Self-tapping screw (M4*30mm)	4	2
D				
E				
F				
G				

1. Place the wall-mounted backboard at a suitable position on the wall, mark the holes to be installed on the wall and the backboard with a marker, and then drill holes on the wall with an electric drill.

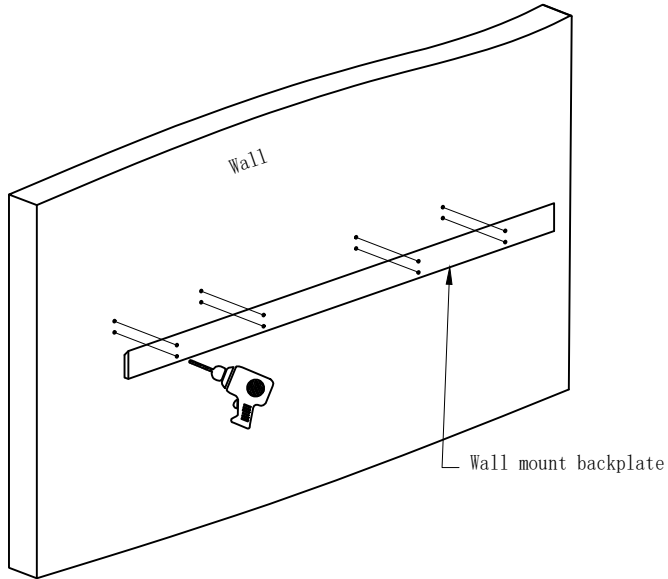

2. After the drilling is completed, insert the expansion plug into the wall hole, place the wall-mounted backboard, and insert the self-tapping screw into the position where the wall hole connects to the backboard hole. Tighten the screws with a screwdriver.

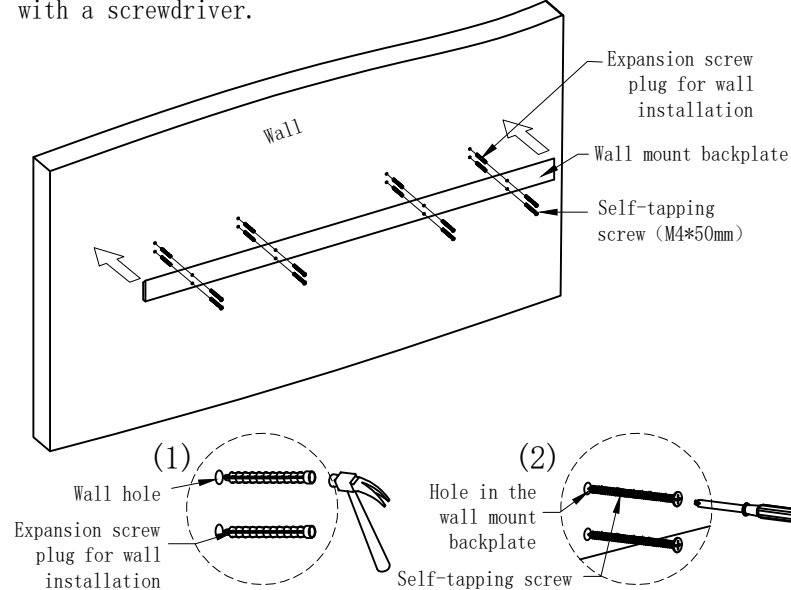

3. Put the TV cabinet on the wall-mounted backboard, open the downward door, insert the self-tapping screws into the holes of the cabinet body, and tighten them with a screwdriver or electric drill.

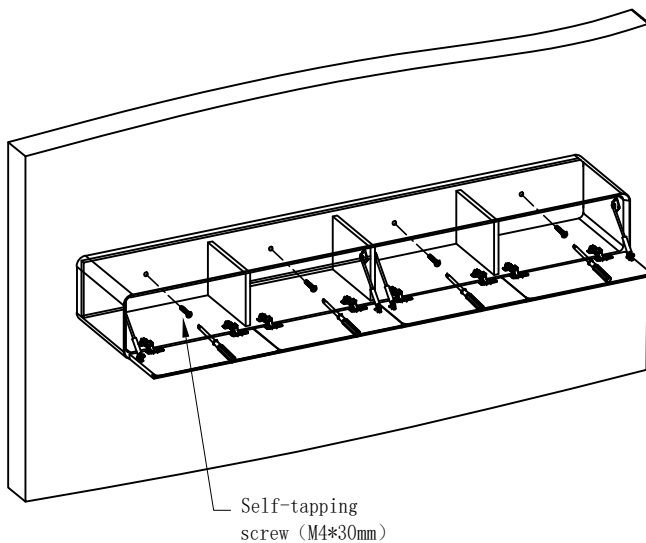

4. Installation complete

