

Assembly instructions

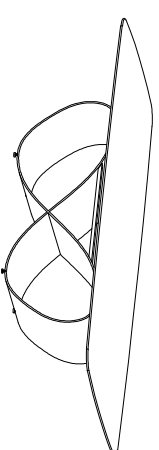

DT8012 Installation

The number of people needed for installation: 2

- ① Please read the manual carefully before installing this product. And strictly follow the installation process
- ② Please take good care of this manual for your next installation
- ③ Note: Before installation, screw all the screws to 1/2 of the length of the installation. After all screws are half screwed in, tighten them all together.

Parts list

On a red ribbon are furniture installation accessories

Serial number	Shape	Name	Quantity required for installation	Spare quantity
A		Socket Head Cap Screw (M8*40mm)	4	3
B		Socket Head Cap Screw (M8*10mm)	4	1
C		Gasket	8	4
D		Nut	4	1
E		Wrench	1	0
F		bottom	0	2
G				

1. Install a metal frame for the main body

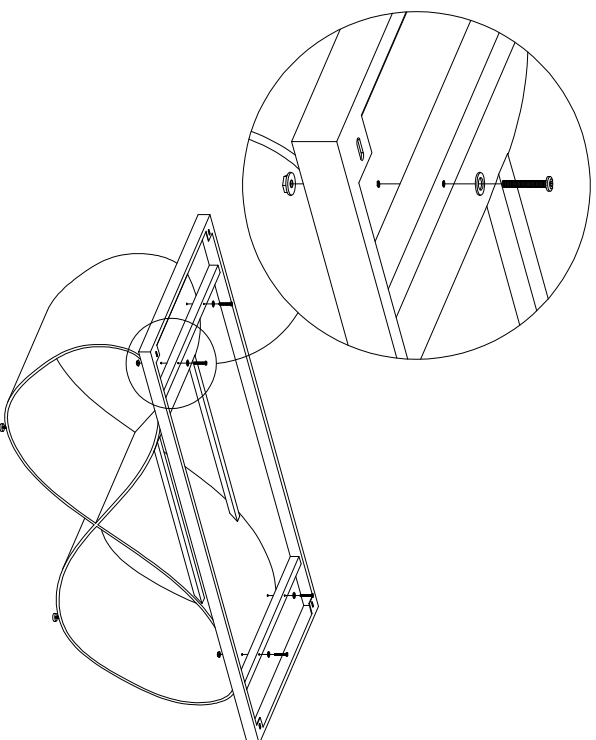

2. Install the tabletop on the main body

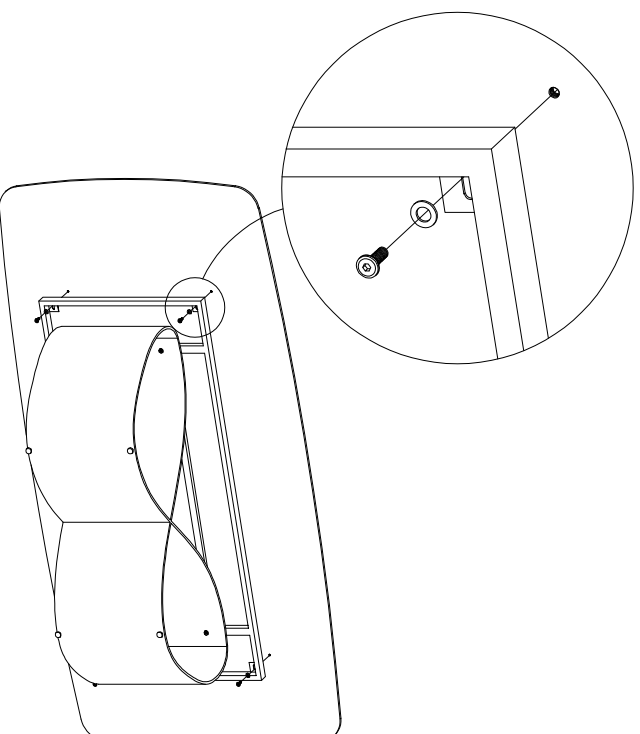

3. The installation is complete

