

1. Install the corner connector(1) at the junction of the bed frame and install the corner connector(2) on both bed sides

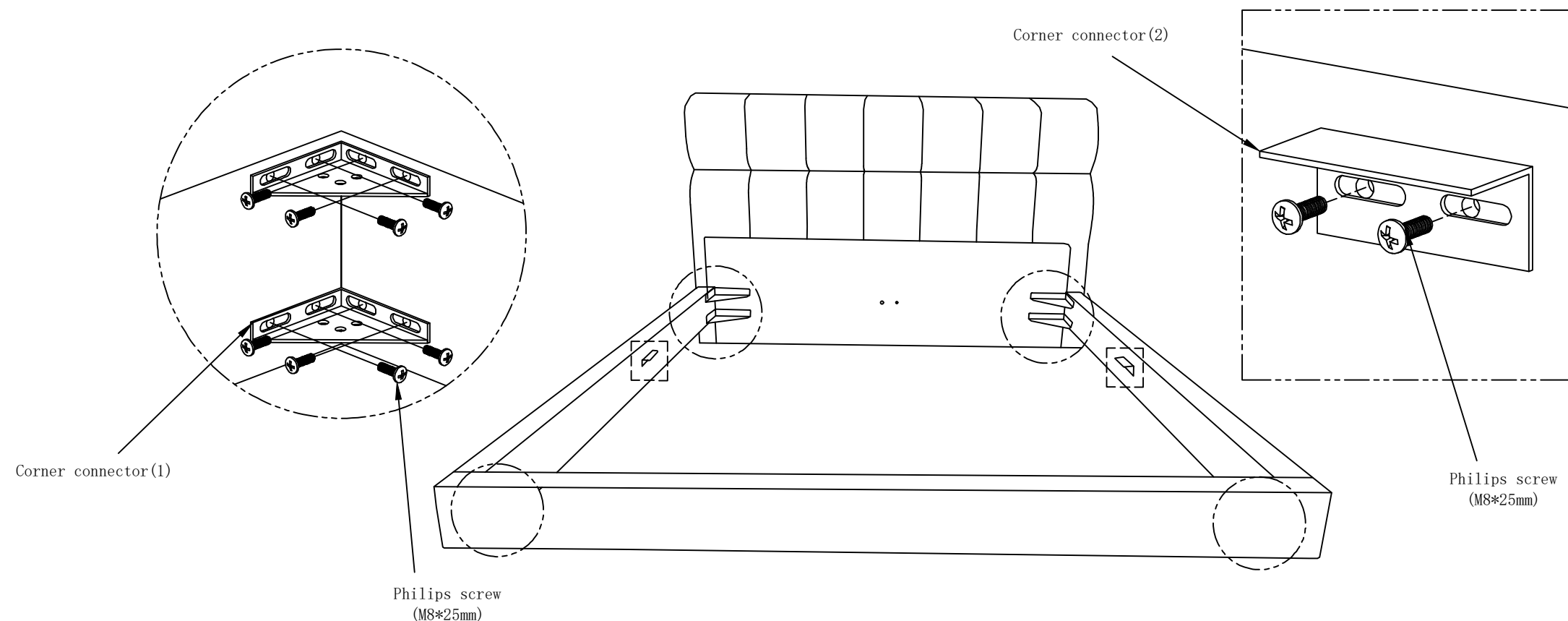

2. Install the support legs(1) at the long corner connector(Paste a non-slip gasket on the bottom of the support leg)

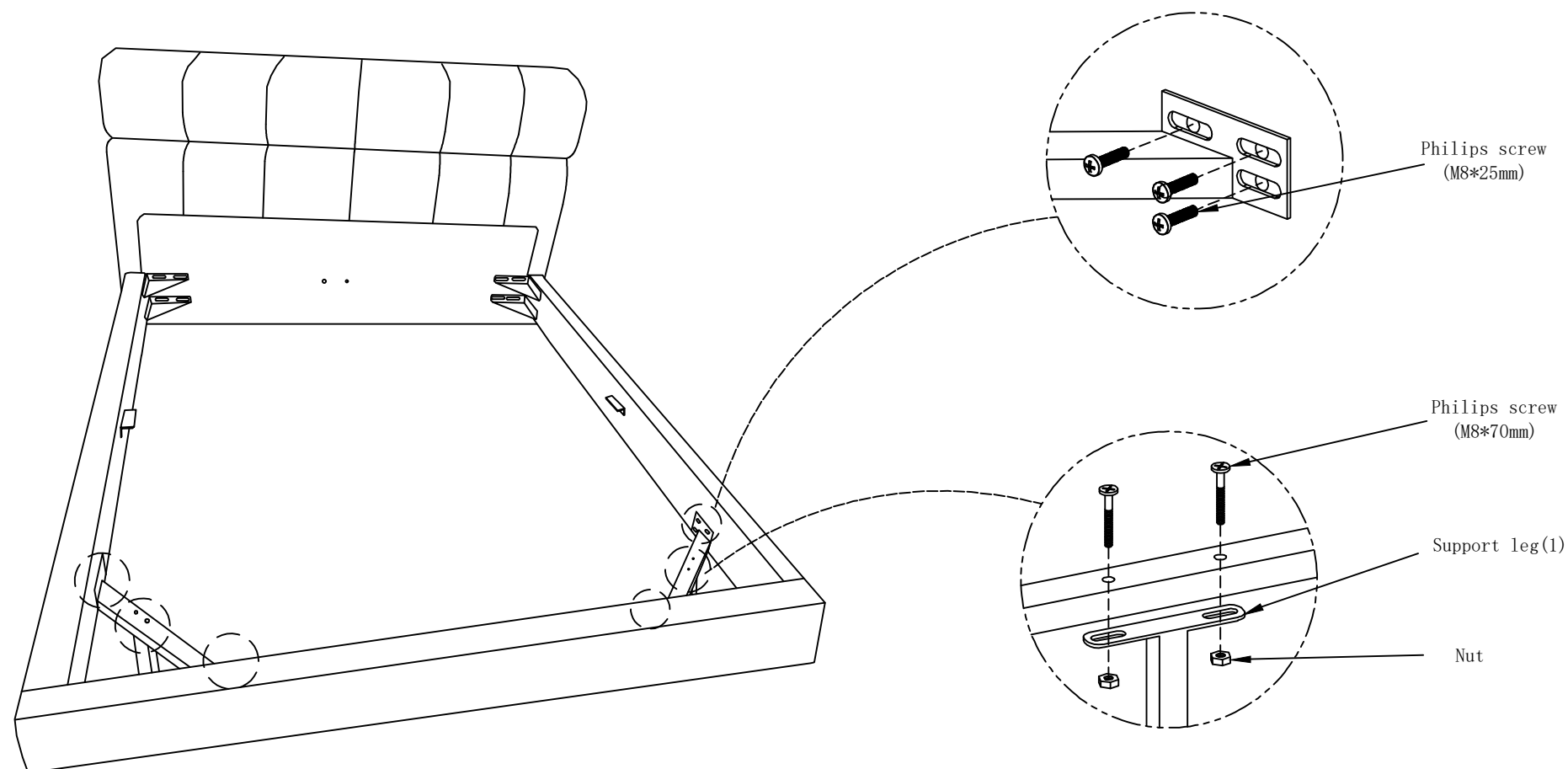

Assembly instructions

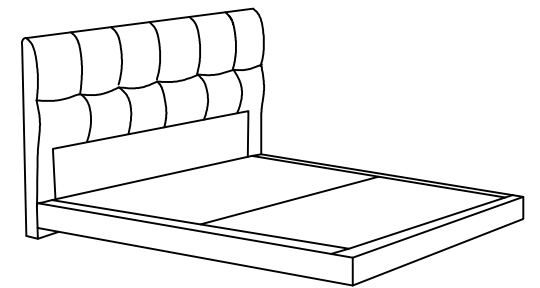

BD8081 Installation

The number of people needed for installation: 2

- ① Please read the manual carefully before installing this product. And strictly follow the installation process
- ② Please take good care of this manual for your next installation
- ③ Note: Before installation, screw all the screws to 1/2 of the length of the installation. After all screws are half screwed in, tighten them all together.

Parts list On a red ribbon are furniture installation accessories

Serial number	Shape	Name	Quantity required for installation	Spare quantity
A		Corner connector(1)	8	0
B		Corner connector(2)	2	0
C		Support leg(1)	2	0
D		Support leg(2)	7	0
E		Long support frame	1	0
F		Long corner connector	2	0
G		Philips screw (M8*25mm)	52	8
H		Philips screw (M8*70mm)	7	1
I		Screw (M8*50mm)	4	1
J		Nut	4	6
K		Non-slip gasket	15	0

3.Install three support legs(2) on the long rod and install the long rod to the corresponding hole position

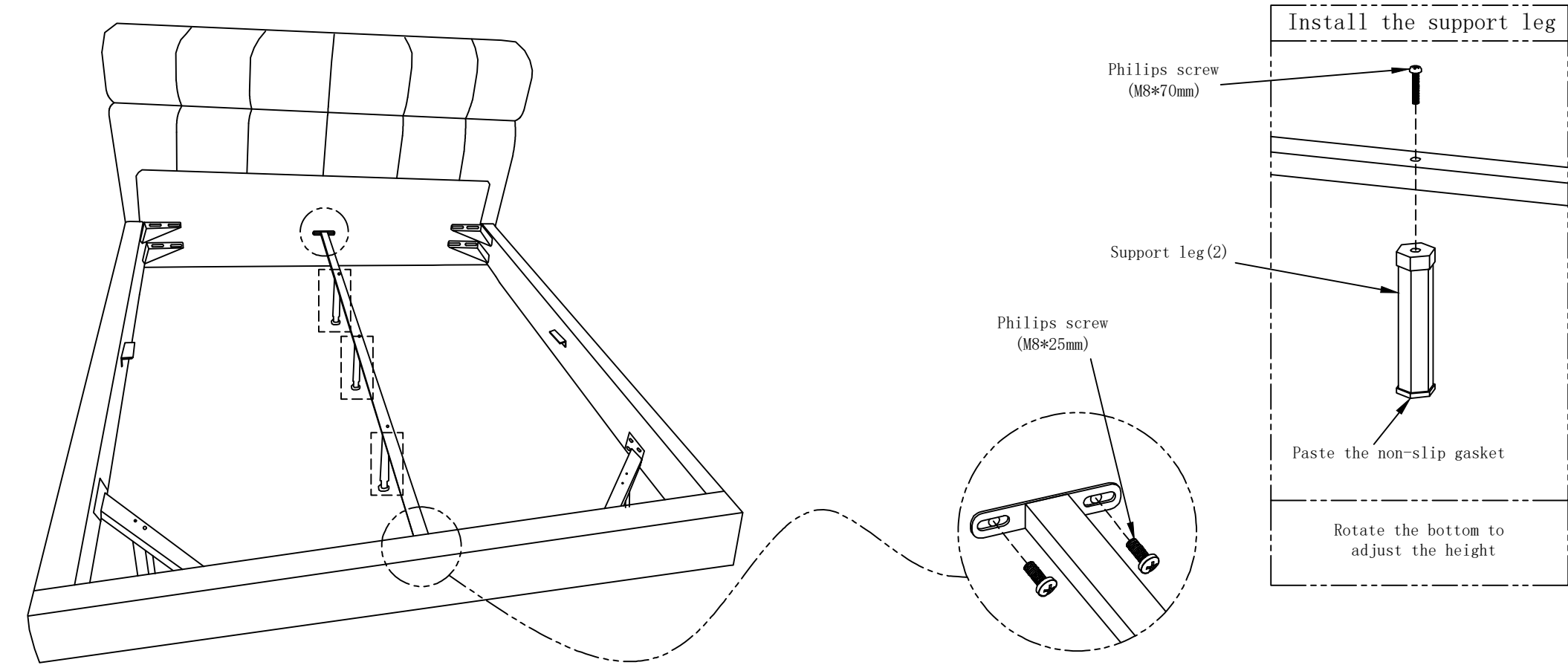

4.Screw the screw into the support feet and install it on the back of the bed board

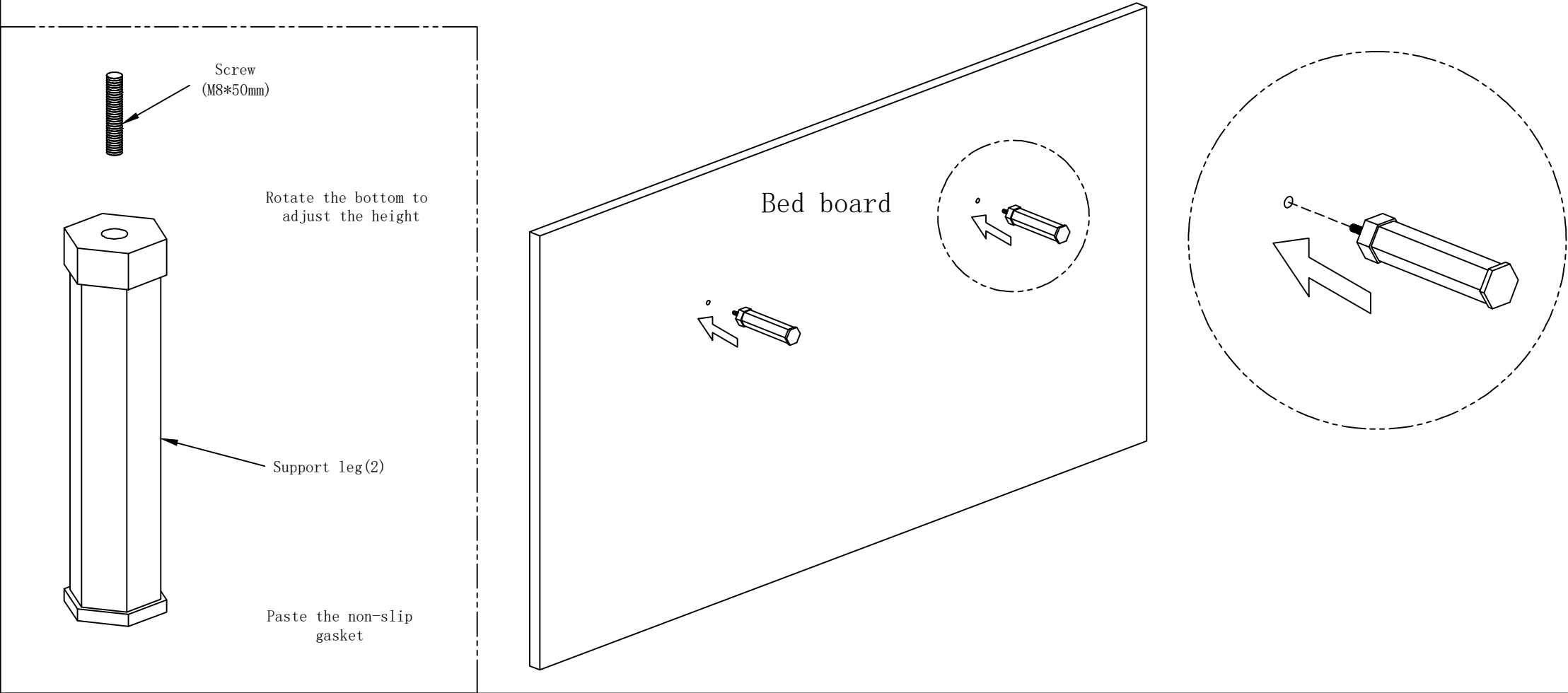

Assembly instructions

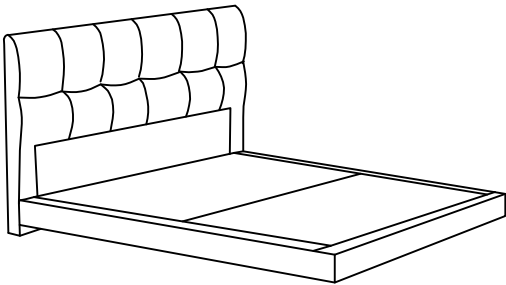

BD8081 Installation
The number of people needed for installation: 2

- ① Please read the manual carefully before installing this product. And strictly follow the installation process
- ② Please take good care of this manual for your next installation
- ③ Note: Before installation, screw all the screws to 1/2 of the length of the installation. After all screws are half screwed in, tighten them all together.

Parts list On a red ribbon are furniture installation accessories

Serial number	Shape	Name	Quantity required for installation	Spare quantity
A		Corner connector(1)	8	0
B		Corner connector(2)	2	0
C		Support leg(1)	2	0
D		Support leg(2)	7	0
E		Long support frame	1	0
F		Long corner connector	2	0
G		Philips screw (M8*25mm)	52	8
H		Philips screw (M8*70mm)	7	1
I		Screw (M8*50mm)	4	1
J		Nut	4	6
K		Non-slip gasket	15	0

5.Put on the bed board

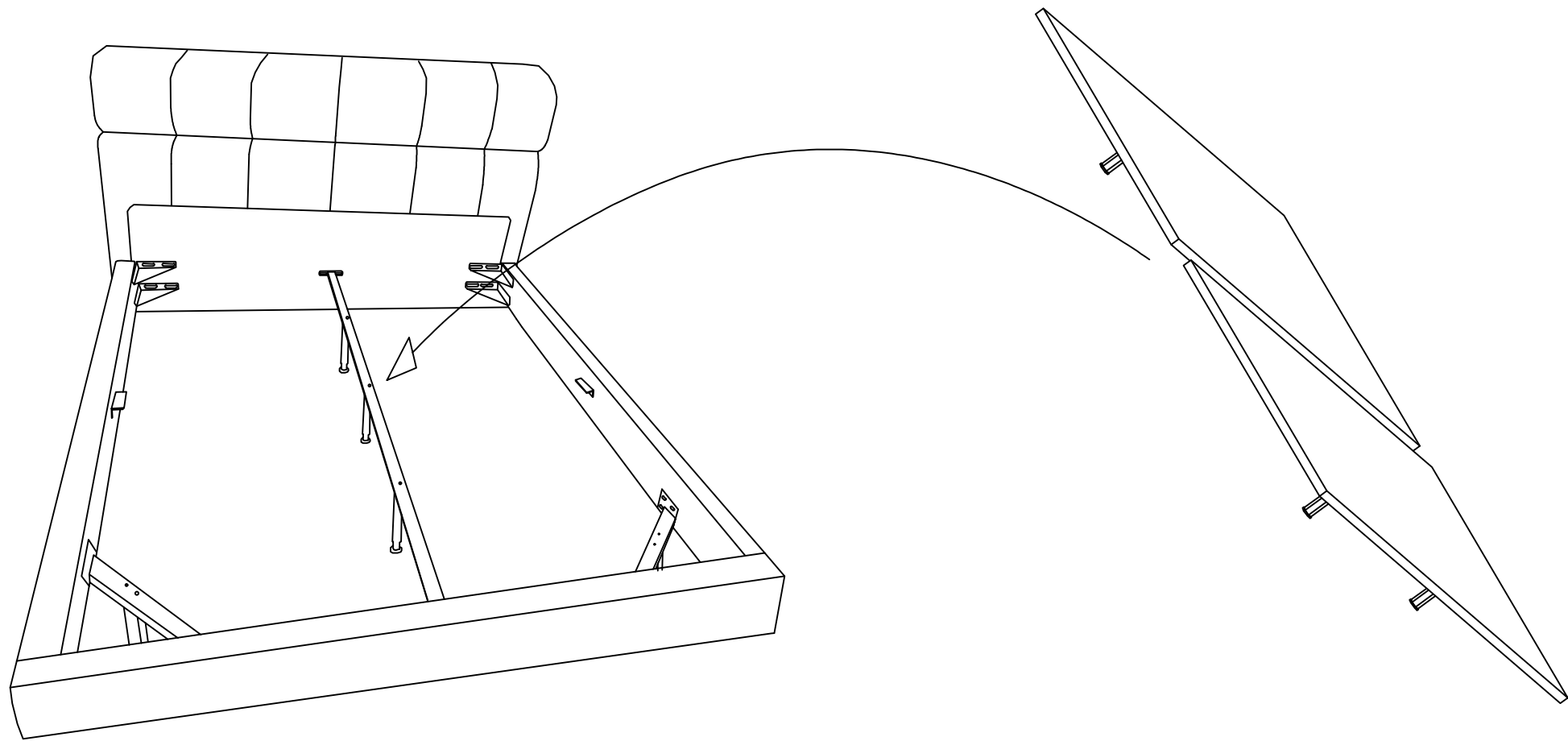

6.The installation is complete

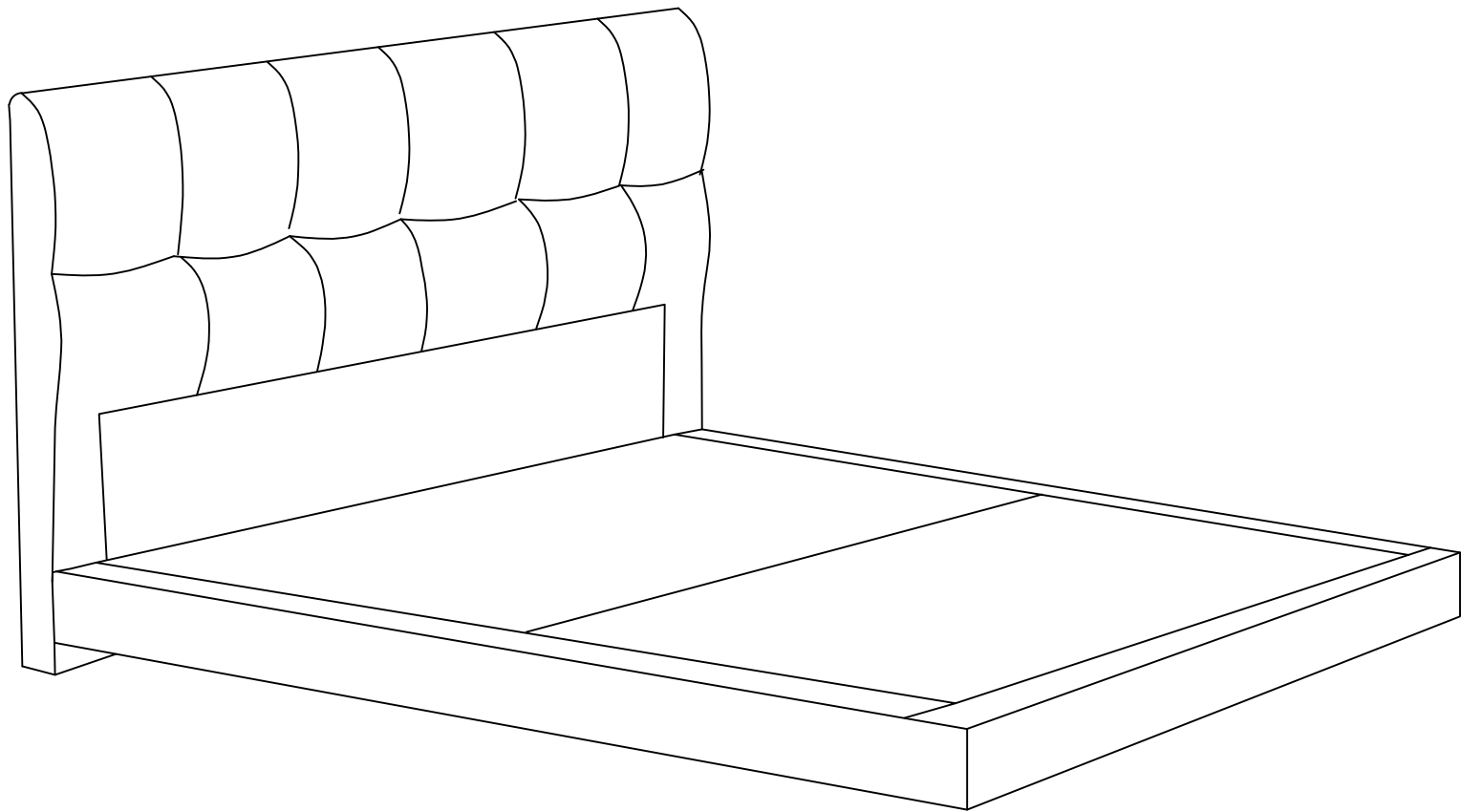

Assembly instructions

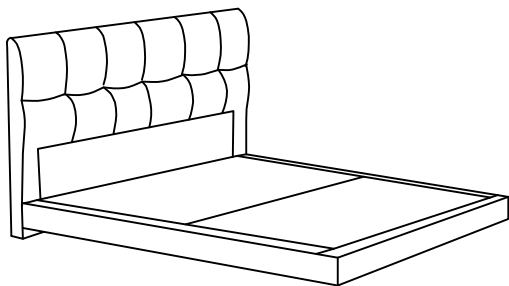

BD8081 Installation

The number of people needed for installation: 2

- ① Please read the manual carefully before installing this product. And strictly follow the installation process
- ② Please take good care of this manual for your next installation
- ③ Note: Before installation, screw all the screws to 1/2 of the length of the installation. After all screws are half screwed in, tighten them all together.

Parts list On a red ribbon are furniture installation accessories

Serial number	Shape	Name	Quantity required for installation	Spare quantity
A		Corner connector(1)	8	0
B		Corner connector(2)	2	0
C		Support leg(1)	2	0
D		Support leg(2)	7	0
E		Long support frame	1	0
F		Long corner connector	2	0
G		Philips screw (M8*25mm)	52	8
H		Philips screw (M8*70mm)	7	1
I		Screw (M8*50mm)	4	1
J		Nut	4	6
K		Non-slip gasket	15	0