

1. Turn the sofa over, fix the position of the Spring Loaded Toggle Latch Catch Clamp with self-tapping screws at the bottom of the sofa, and simply connect and lock the sofa modules. (there is no hole at the bottom of the couch you need to locate and drive the screw by yourself).

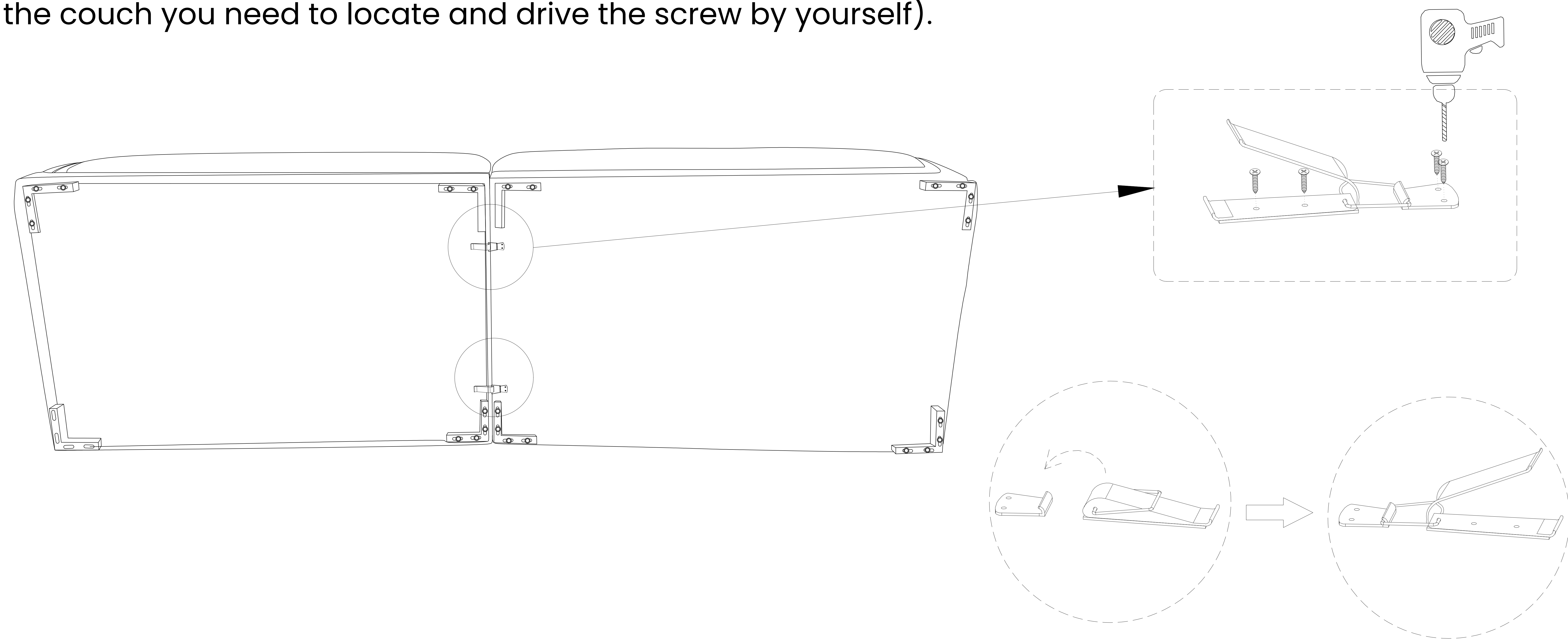

2. Installation completed.

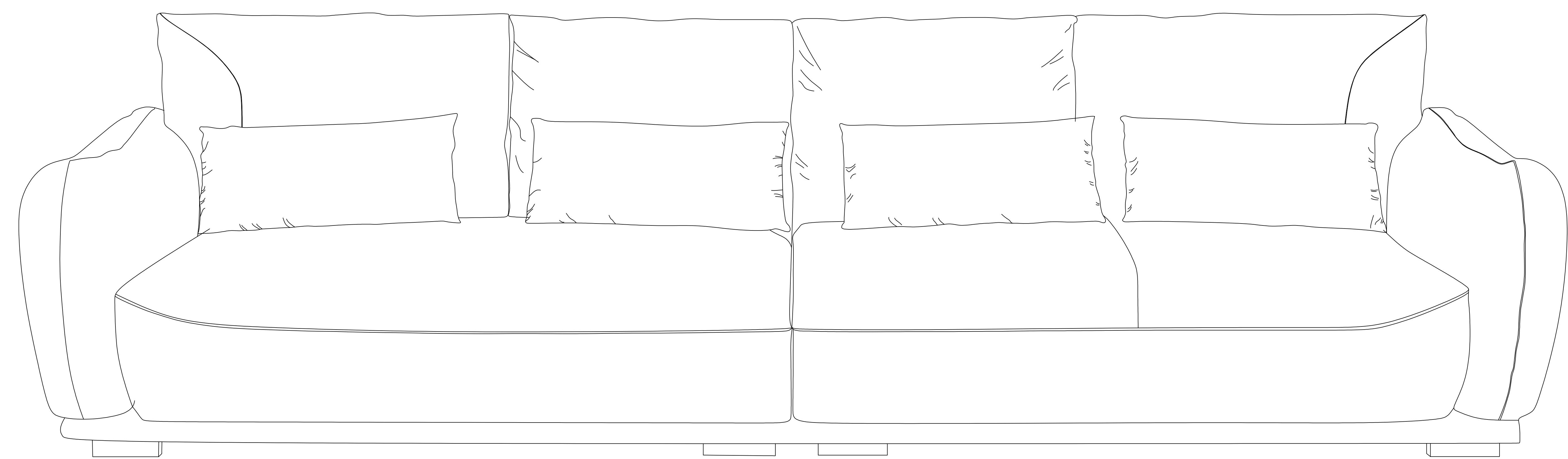

Assembly instructions

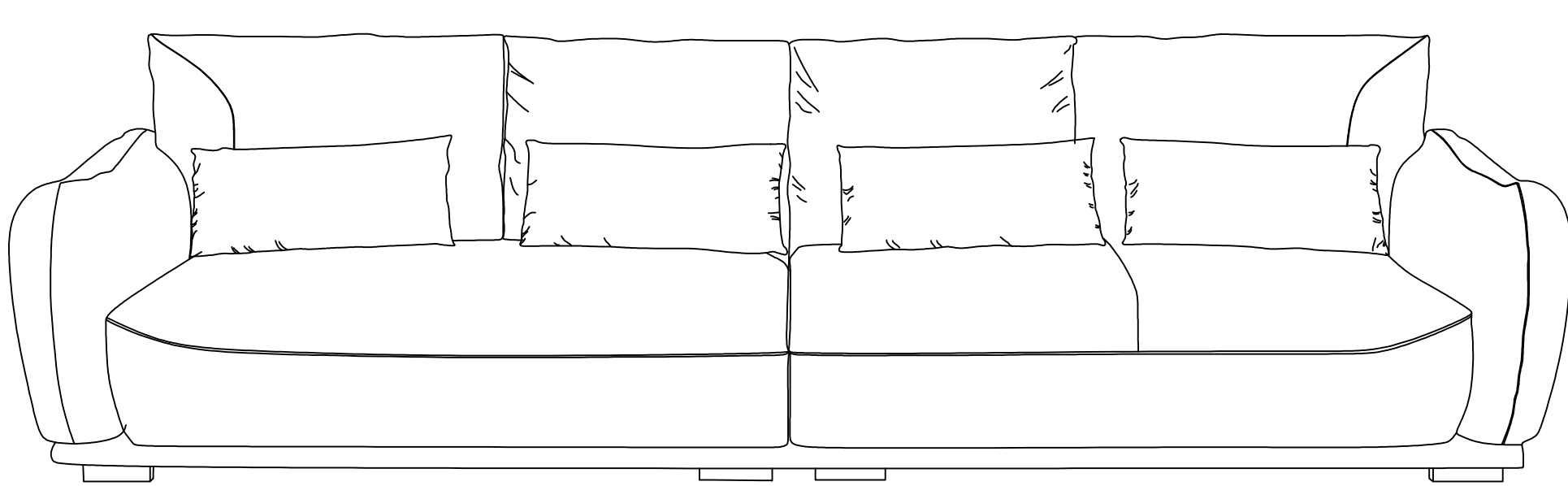

SF8031E320I Installation  
The number of people needed for installation: 2

- ① Please read the manual carefully before installing this product. And strictly follow the installation process
- ② Please take good care of this manual for your next installation
- ③ Note: Before installation, screw all the screws to 1/2 of the length of the installation. After all screws are half screwed in, tighten them all together.

Parts list		On a red ribbon are furniture installation accessories		
Serial number	Shape	Name	Quantity required for installation	Spare quantity
A		Self-Drilling Screw (M8*30mm)	8	2
B		Spring Loaded Toggle Latch Catch Clamp	2	0
C				
D				
E				
F				
G				